

JL/JT Front Axle Shaft kits (U-Joint) installation instructions

IMPORTANT NOTES

Prior to beginning this install, or any installation, read the instructions thoroughly to familiarize yourself with the required steps.

Refer to the parts list to ensure that all necessary components and hardware has been included.

If any parts are missing, please contact your local dealer for assistance.

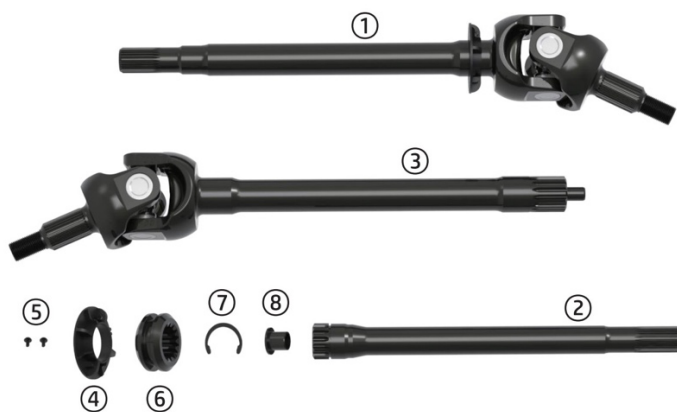

Item No.	Description	Qty
1	U-Joint axle shaft/ left	1
2	U-Joint axle shaft/right/inner	1
3	U-Joint axle shaft/right/outer	1
4	Dust baffle	4
5	Self-tapping screw with pad	5
6	Axle dis-connect slide clutch collar	1
7	Shaft circlip	1
8	Bushing for inner axle shaft	1

4XZONE FOR THOSE ABOUT TO ROCK

4xzone U-Joint front axle shaft comes fully assembled at the factory so you can follow the normal process of replacing your weak stock front axle shaft.

There are still a few points to note.

1.The dust baffle is flush with the axle port.

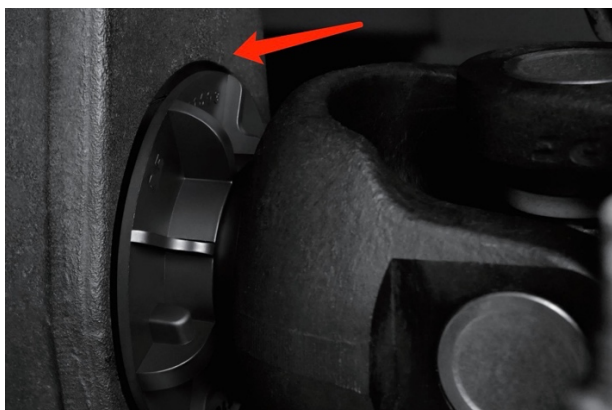

2.Tighten the Half shaft nut and Bearing cap bolts to the proper torque, we give the following suggestions.

Axle	Description	N·m	Ft. Lbs.
M186/M210	Half shaft nut	136	100
	Bearing cap bolts	108	80

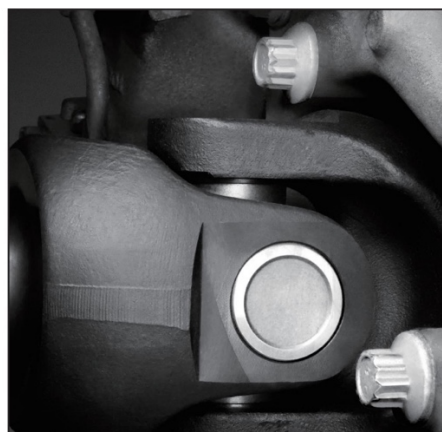
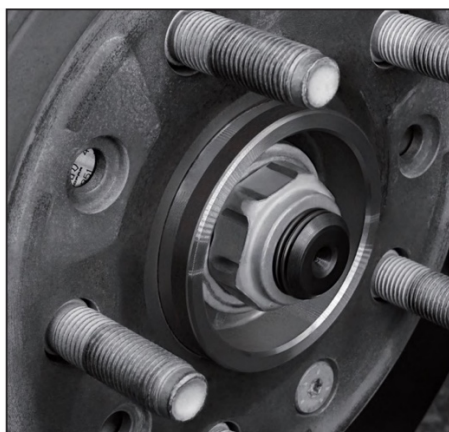

3. If your axle has a differential lock, you need to add gear oil marked 75w-140; If your axle does not have a differential lock you need to add gear oil marked 80w-90.